

KEY PLAN

NOTES REGARDING DECLARATION OF FLOOD LEVELS

- 1 The flood level lines shown on this plan define the surface level of the "1% probability flood". This is the flood prescribed by Sec 201 of the Water Act - 1989, for floodplain management purposes and has a 1 in 100 chance of being equalled or exceeded in any one year.
- 2 The derivation of these 1% flood level lines has been based on available historical flood level and flow information, hydrologic and hydraulic modelling.
- 3 Areas outside the 1% probability flood limit may be inundated by rarer flood events.
- 4 For the purpose of determining flood levels for locations between flood level lines, it can be assumed that the flood surface levels change at a uniform rate between flood level lines.
- 5 The flood level lines shown on this plan can be used to assist in the determination of designated levels in accordance with Clause 62 of the Building Regulations - 1994.
- 6 Although there may be buildings within the area covered by the flood level lines, it should not be assumed that the floor of any individual building is below flood level. Buildings should be surveyed to determine whether their floors are above or below the 1% flood level.

ANG. ZONE 55 NORTH

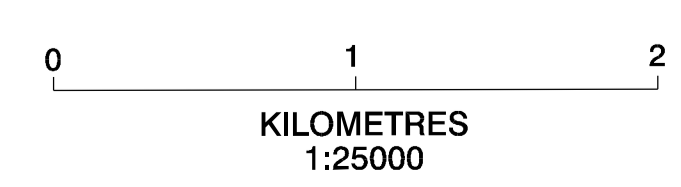
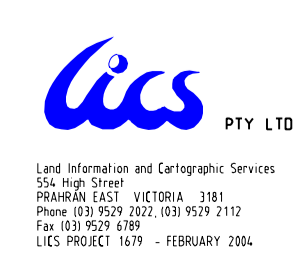

E 31000
N 6022000

E 321000
N 6022000

E 31000
N 601000

E 321000
N 601000

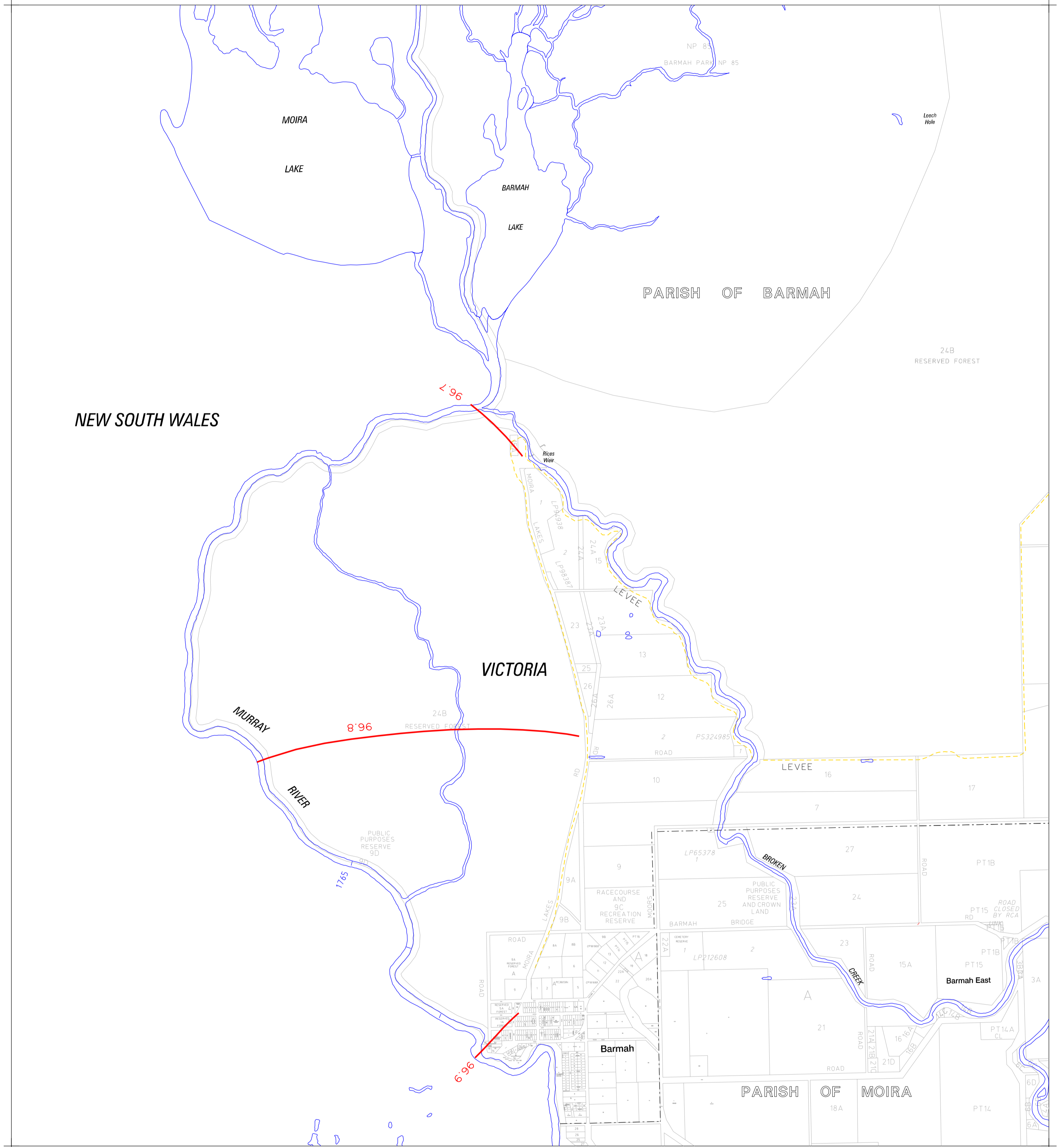

DECLARATION DATE ...19th AUGUST 2004...

NOTES	Base of these maps was prepared as part of a Flood Mapping Project for MDBE (1993) Reference Plan Number 500049 / Map 1.99		LEGEND			MURRAY RIVER - LAKE HUME TO SOUTH AUSTRALIAN BORDER MURRAY RIVER - 1% FLOOD LEVEL DECLARATION LAKE MULWALA TO ECHUCA GOULBURN BROKEN CATCHMENT MANAGEMENT AUTHORITY	
	MAP BASE IS CADASTRAL AND 1:25000 TOPOGRAPHIC DIGITAL DATA ACQUIRED UNDER LAND VICTORIA (DMRE) LICENCE AGREEMENT (DATE PROVIDED - FEBRUARY 1998)	REFERENCES					